



3/27/18
3/26/18

Town and Country Planning Act 1990

The Rother District Council (Land adj to Freezeland Farm, Ninfield Road, Bexhill on Sea – TPO388) Tree Preservation Order 2018

The Rother District Council, in exercise of the powers conferred on them by section 198 of the Town and Country Planning Act 1990 make the following Order

Citation

1. This Order may be cited as the **Rother District Council Land adj to Freezeland Farm, Ninfield Road, Bexhill on Sea – TPO388) Tree Preservation Order 2018.**

Interpretation

2. (1) In this Order “the authority” means the Rother District Council.
(2) In this Order any reference to a numbered section is a reference to the section so numbered in the Town and Country Planning Act 1990 and any reference to a numbered regulation is a reference to the regulation so numbered in the Town and Country Planning (Tree Preservation)(England) Regulations 2012.

Effect

3. (1) Subject to article 4, this Order takes effect provisionally on the date on which it is made.
(2) Without prejudice to subsection (7) of section 198 (power to make tree preservation orders) or subsection (1) of section 200 (tree preservation orders: Forestry Commissioners) and, subject to the exceptions in regulation 14, no person shall—
(a) cut down, top, lop, uproot, wilfully damage, or wilfully destroy; or
(b) cause or permit the cutting down, topping, lopping, wilful damage or wilful destruction of, any tree specified in the Schedule to this Order except with the written consent of the authority in accordance with regulations 16 and 17, or of the Secretary of State in accordance with regulation 23, and, where such consent is given subject to conditions, in accordance with those conditions.

Application to trees to be planted pursuant to a condition

4. In relation to any tree identified in the first column of the Schedule by the letter “C”, being a tree to be planted pursuant to a condition imposed under paragraph (a) of section 197 (planning permission to include appropriate provision for preservation and planting of trees), this Order takes effect as from the time when the tree is planted.

Dated this 12th day of March 2018

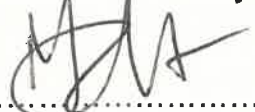
.....
Executive Director, Rother District Council

.....
Member of the Rother District Council



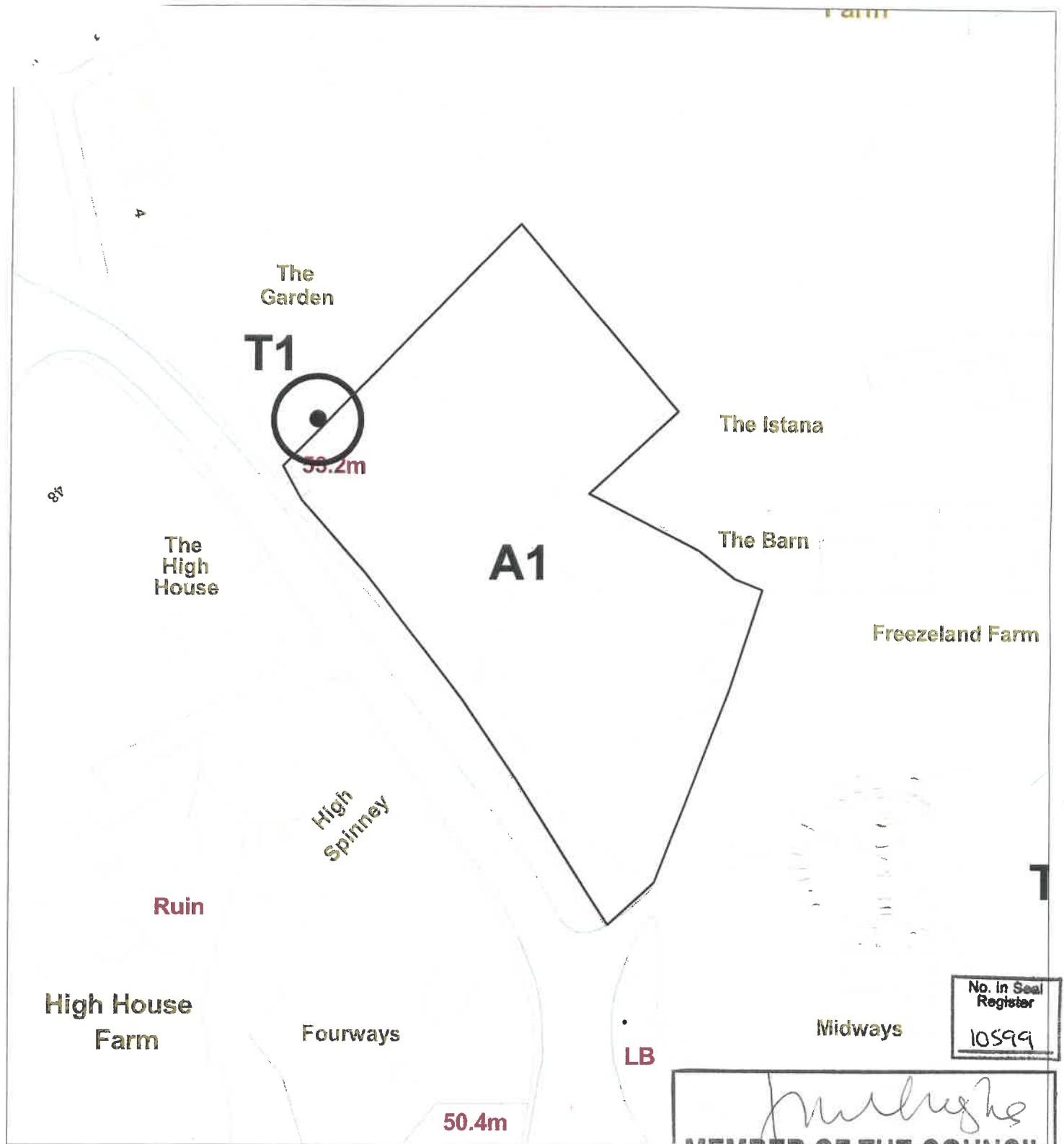

Rother District Council Planning Division

Town Hall, Bexhill-on-Sea TEL: 01424-787631

Land adjacent to Freezeland Farm,
Ninfield Road,
Bexhill

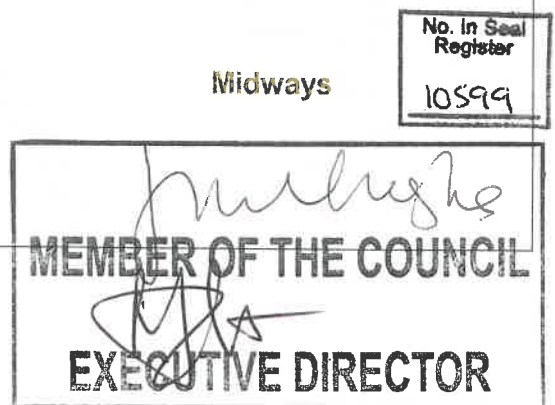

File: TPO 388

Scale: 1:1000

Grid Reference: TQ7210SE

Date: 09/03/2018

Specification of trees

Trees specified individually (encircled in black on the map)

<i>Reference on map</i>	<i>Description</i>	<i>Situation</i>
T.1.	Monterey Pine	Land to the north east of Ninfield Road, near to the corner of Freezeland Lane, Bexhill on Sea, in the District of Rother.

Trees specified by reference to an area (within a dotted black line on the map)

<i>Reference on map</i>	<i>Description</i>	<i>Situation</i>
A.1.	All trees of whatever species comprising mainly broadleaved specimens.	Land to the north east of Ninfield Road, near to the corner of Freezeland Lane, Bexhill on Sea, in the District of Rother.

Groups of trees (within a broken black line on the map)

<i>Reference on map</i>	<i>Description (including number of trees of each species in the group)</i>	<i>Situation</i>
	None	

Woodlands (within a continuous black line on the map)

<i>Reference on map</i>	<i>Description</i>	<i>Situation</i>
	None	