

Junction: J4: A269/London Rd Bus Gate	
J4:1/1	650
J4:1/2	360
J4:2/1	2
J4:3/1	828
J4:4/1	825
J4:5/1	3
J4:6/1	651
J4:6/2	361

## Lane Saturation Flows

Junction: J1: A259/A269										
Lane	Lane Width (m)	Gradient	Nearside Lane	Allowed Turns	Turning Radius (m)	Turning Prop.	Sat Flow (PCU/Hr)	Flared Sat Flow (PCU/Hr)		
J1:1/1 (A259 Little Common Road (W))	3.65	0.00	Y	Arm J4:3 Left	23.00	100.0 %	1859	1859		
J1:1/2 (A259 Little Common Road (W))	3.65	0.00	N	Arm J1:6 Ahead	Inf	100.0 %	2120	2120		
J1:1/3 (A259 Little Common Road (W))	3.65	0.00	N	Arm J1:6 Ahead	Inf	0.0 %	2120	2120		
J1:1/4 (A259 Little Common Road (W))	3.65	0.00	N	Arm J1:7 Right	15.00	100.0 %	1927	1927		
J1:2/1 (A259 Belle Hill (E))	3.30	0.00	Y	Arm J1:5 Ahead	Inf	77.3 %	1881	1881		
				Arm J1:7 Left	10.00	22.7 %				
J1:2/2 (A259 Belle Hill (E))	3.30	0.00	N	Arm J1:5 Ahead	Inf	100.0 %	2085	2085		
J1:2/3 (A259 Belle Hill (E))	3.30	0.00	N	Arm J4:3 Right	15.00	100.0 %	1895	1895		
J1:3/1 (A269 Combe Valley Way)	3.50	0.00	Y	Arm J1:6 Left	18.00	17.5 %	1937	1937		
				Arm J1:7 Ahead	Inf	82.5 %				
J1:3/2 (A269 Combe Valley Way)	3.75	0.00	N	Arm J1:5 Right	15.00	100.0 %	1936	1936		
J1:4/1 (A269 London Road)	2.75	0.00	Y	Arm J1:5 Left	17.00	56.4 %	1800	1800		
				Arm J4:3 Ahead	Inf	43.6 %				
J1:4/2 (A269 London Road)	2.75	0.00	N	Arm J1:6 Right	16.00	100.0 %	1856	1856		
J1:5/1			Infinite Saturation Flow					Inf	Inf	
J1:5/2			Infinite Saturation Flow					Inf	Inf	
J1:6/1			Infinite Saturation Flow					Inf	Inf	
J1:6/2			Infinite Saturation Flow					Inf	Inf	
J1:7/1			Infinite Saturation Flow					Inf	Inf	

Junction: J2: A259/Downs Road										
Lane	Lane Width (m)	Gradient	Nearside Lane	Allowed Turns	Turning Radius (m)	Turning Prop.	Sat Flow (PCU/Hr)	Flared Sat Flow (PCU/Hr)		
J2:1/1 (A259 Little Common Road)	3.50	0.00	Y	Arm J1:1 Ahead Arm J2:5 Left	Inf 11.00	94.5 % 5.5 %	1950	1950		
J2:1/2 (A259 Little Common Road)	3.50	0.00	Y	Arm J1:1 Ahead	Inf	100.0 %	1965	1965		
J2:2/1 (Downs Road)	4.00	0.00	Y	Arm J1:1 Left	11.00	100.0 %	1773	1773		
J2:2/2 (Downs Road)	2.50	0.00	N	Arm J2:4 Right	11.00	100.0 %	1764	1764		
J2:3/1 (A259 Belle Hill East)	3.35	0.00	Y	Arm J2:4 Ahead	Inf	100.0 %	1950	1950		
J2:3/2 (A259 Belle Hill East)	3.30	0.00	N	Arm J2:4 Ahead	Inf	100.0 %	2085	2085		
J2:3/3 (A259 Belle Hill East)	2.60	0.00	N	Arm J2:5 Right	6.00	100.0 %	1612	1612		
J2:4/1	Infinite Saturation Flow									
J2:5/1	Infinite Saturation Flow									

Junction: J3: London Road / Beeching Road										
Lane	Lane Width (m)	Gradient	Nearside Lane	Allowed Turns	Turning Radius (m)	Turning Prop.	Sat Flow (PCU/Hr)	Flared Sat Flow (PCU/Hr)		
J3:1/1 (London Road South)	3.80	0.00	Y	Arm J1:4 Ahead Arm J3:4 Left	Inf 9.00	97.8 % 2.2 %	1988	1988		
J3:2/1 (Beeching Road)	3.85	0.00	Y	Arm J1:4 Left Arm J3:5 Right	8.00 5.00	97.5 % 2.5 %	1680	1680		
J3:3/1 (London Road North)	3.95	0.00	Y	Arm J3:4 Right Arm J3:5 Ahead	6.00 Inf	26.8 % 73.2 %	1884	1884		
J3:4/1	Infinite Saturation Flow									
J3:5/1	Infinite Saturation Flow									

Junction: J4: A269/London Rd Bus Gate								
Lane	Lane Width (m)	Gradient	Nearside Lane	Allowed Turns	Turning Radius (m)	Turning Prop.	Sat Flow (PCU/Hr)	Flared Sat Flow (PCU/Hr)
J4:1/1 (A269 North Lane 1)			Infinite Saturation Flow				Inf	Inf
J4:1/2 (A269 North Lane 2)			Infinite Saturation Flow				Inf	Inf
J4:2/1 (London Road Lane 1)			Infinite Saturation Flow				Inf	Inf
J4:3/1 (A269 South Lane 1)			Infinite Saturation Flow				Inf	Inf
J4:4/1			Infinite Saturation Flow				Inf	Inf
J4:5/1			Infinite Saturation Flow				Inf	Inf
J4:6/1			Infinite Saturation Flow				Inf	Inf
J4:6/2			Infinite Saturation Flow				Inf	Inf

**Stage Sequence Diagram**

**Scenario 1: '2018 Surveyed - Validation - AM Peak' (FG1: '2018 Surveyed Flows (Extracted from Prime TA) - AM Peak', Plan 1: 'Capture Double')**

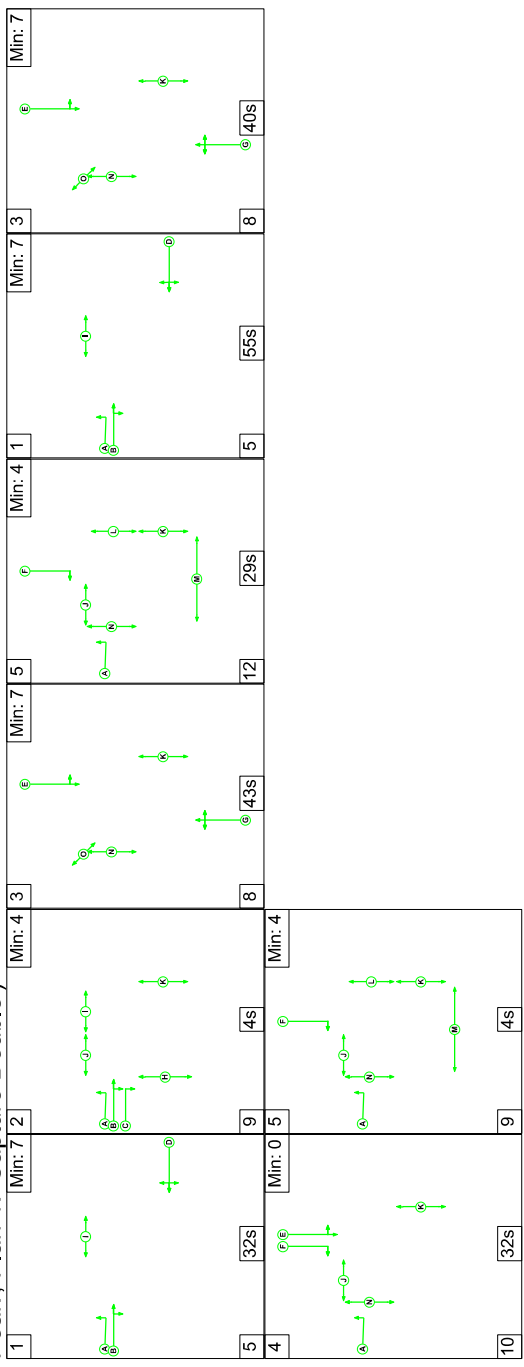

### Network Layout Diagram

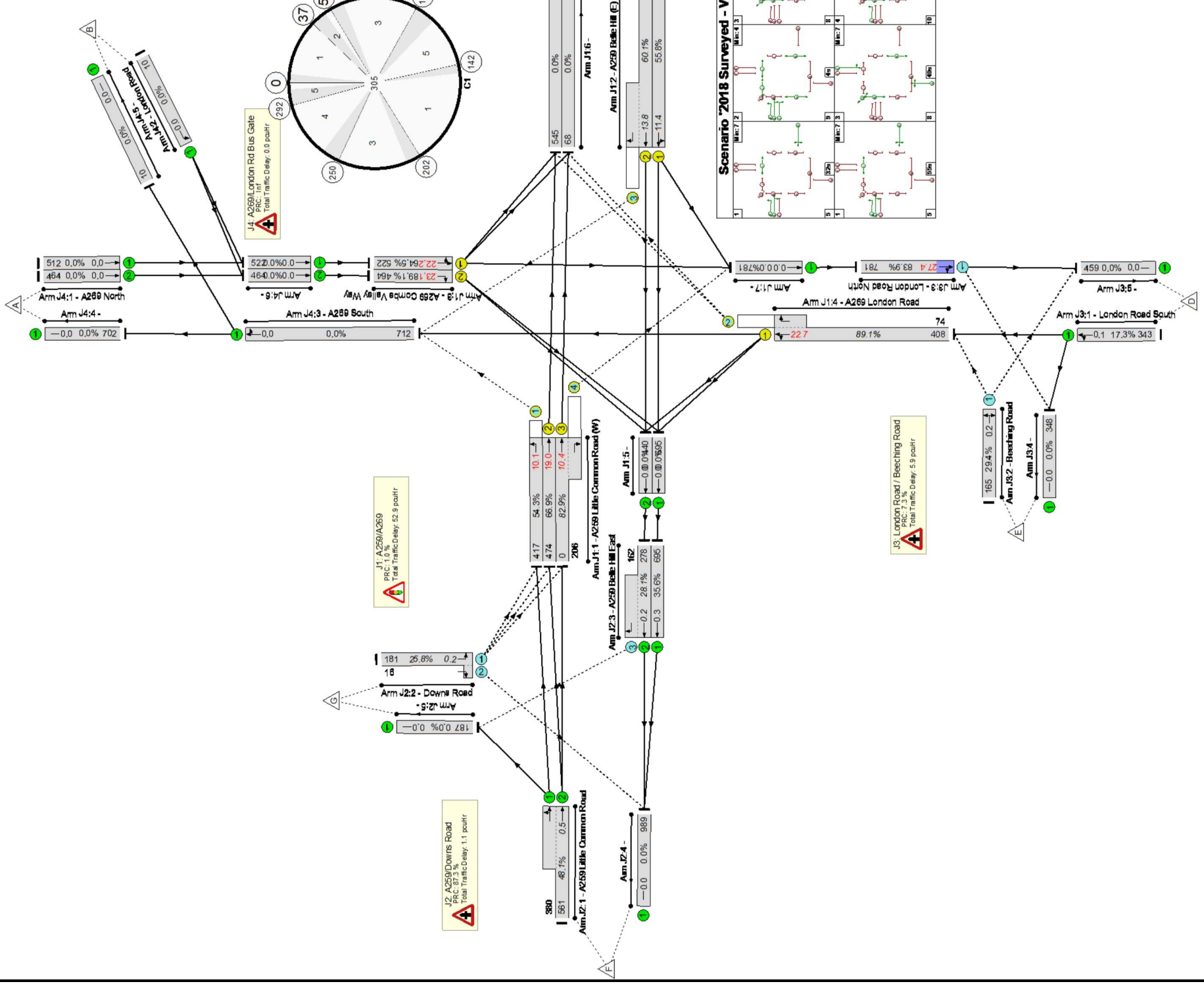

**Network Results**

Item	Lane Description	Full Phase	Demand Flow (pcu)	Sat Flow (pcu/Hr)	Capacity (pcu)	Deg Sat (%)	Uniform Delay (pcuHr)	Rand + Oversat Delay (pcuHr)	Total Delay (pcuHr)	Av. Delay Per PCU (s/pcu)	Max. Back of Uniform Queue (pcu)	Rand + Oversat Queue (pcu)	Mean Max Queue (pcu)
<b>Network: A259/A269 Existing Layout</b>	-	-	-	-	-	<b>89.1%</b>	<b>40.8</b>	<b>17.3</b>	<b>59.9</b>	-	-	-	-
<b>J1: A259/A269</b>	-	-	-	-	-	<b>89.1%</b>	<b>37.7</b>	<b>13.4</b>	<b>52.9</b>	-	-	-	-
1/1	A259 Little Common Road (W) Left	A	417	1859	767	54.3%	1.7	0.6	2.5	21.2	9.5	0.6	10.1
1/2	A259 Little Common Road (W) Ahead	B	474	2120	709	66.9%	5.7	1.0	6.7	51.2	18.0	1.0	19.0
1/3+1/4	A259 Little Common Road (W) Ahead Right	B	206	2120:1927	248	82.9%	2.5	2.2	5.7	100.3	8.2	2.2	10.4
2/1	A259 Belle Hill (E) Ahead Left	D	299	1836	536	55.8%	3.8	0.6	4.4	53.3	10.8	0.6	11.4
2/2+2/3	A259 Belle Hill (E) Ahead Right	D	377	2085:1895	628	60.1%	4.8	0.7	5.7	54.3	13.0	0.7	13.8
3/1	A269 Combe Valley Way Left Ahead	E	522	1945	810	64.5%	5.4	0.9	6.3	43.3	21.3	0.9	22.2
3/2	A269 Combe Valley Way Right	F	464	1936	520	89.1%	6.9	3.6	10.6	82.0	19.5	3.6	23.1
4/1+4/2	A269 London Road Left Right Ahead	G	482	1833:1856	541	89.1%	6.9	3.6	11.0	82.0	19.0	3.6	22.7
<b>J2: A259/Downs Road</b>	-	-	-	-	-	<b>48.1%</b>	<b>0.0</b>	<b>1.1</b>	<b>1.1</b>	-	-	-	-
1/2+1/1	A259 Little Common Road Ahead Left	-	941	1965:1948	1958	48.1%	0.0	0.5	0.5	1.8	0.0	0.5	0.5
2/1+2/2	Downs Road Left Right	-	197	1773:1764	765	25.8%	0.0	0.2	0.2	3.2	0.0	0.2	0.2
3/1	A259 Belle Hill East Ahead	-	695	1950	1950	35.6%	0.0	0.3	0.3	1.4	0.0	0.3	0.3
3/2+3/3	A259 Belle Hill East Ahead Right	-	440	2085:1612	1566	28.1%	0.0	0.2	0.2	1.6	0.0	0.2	0.2
<b>J3: London Road / Beeching Road</b>	-	-	-	-	-	<b>83.9%</b>	<b>3.1</b>	<b>2.8</b>	<b>5.9</b>	-	-	-	-
1/1	London Road South Ahead Left	-	343	1982	1982	17.3%	0.0	0.1	0.1	1.1	0.0	0.1	0.1

Full Input Data And Results

2/1	Beeching Road Left Right	-	165	1673	560	29.4%	0.0	0.2	0.2	4.5	0.0	0.2	0.2
3/1	London Road North Right Ahead	-	781	1816	931	83.9%	3.1	2.5	5.6	25.8	24.9	2.5	27.4
<b>J4: A269/London Rd Bus Gate</b>	-	-	-	-	-	<b>0.0%</b>	<b>0.0</b>	<b>0.0</b>	<b>0.0</b>	-	-	-	-
C1		PRC for Signalled Lanes (%):		1.0	Total Delay for Signalled Lanes (pcuHr):		52.87	Cycle Time (s):		305			
		PRC Over All Lanes (%):		1.0	Total Delay Over All Lanes(pcuHr):		59.88						

**Stage Sequence Diagram**

**Scenario 2: '2018 Surveyed - Validation - PM Peak' (FG2: '2018 Surveyed Flows (Extracted from Prime TA) - PM peak', Plan 1: 'Capture Double')**

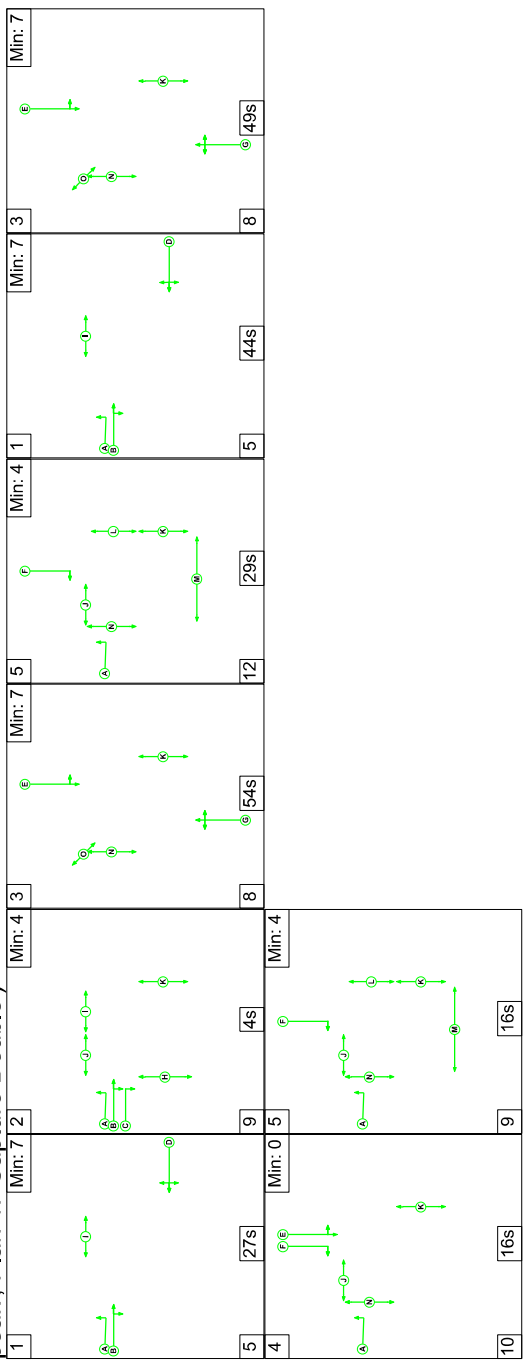



Network Layout Diagram

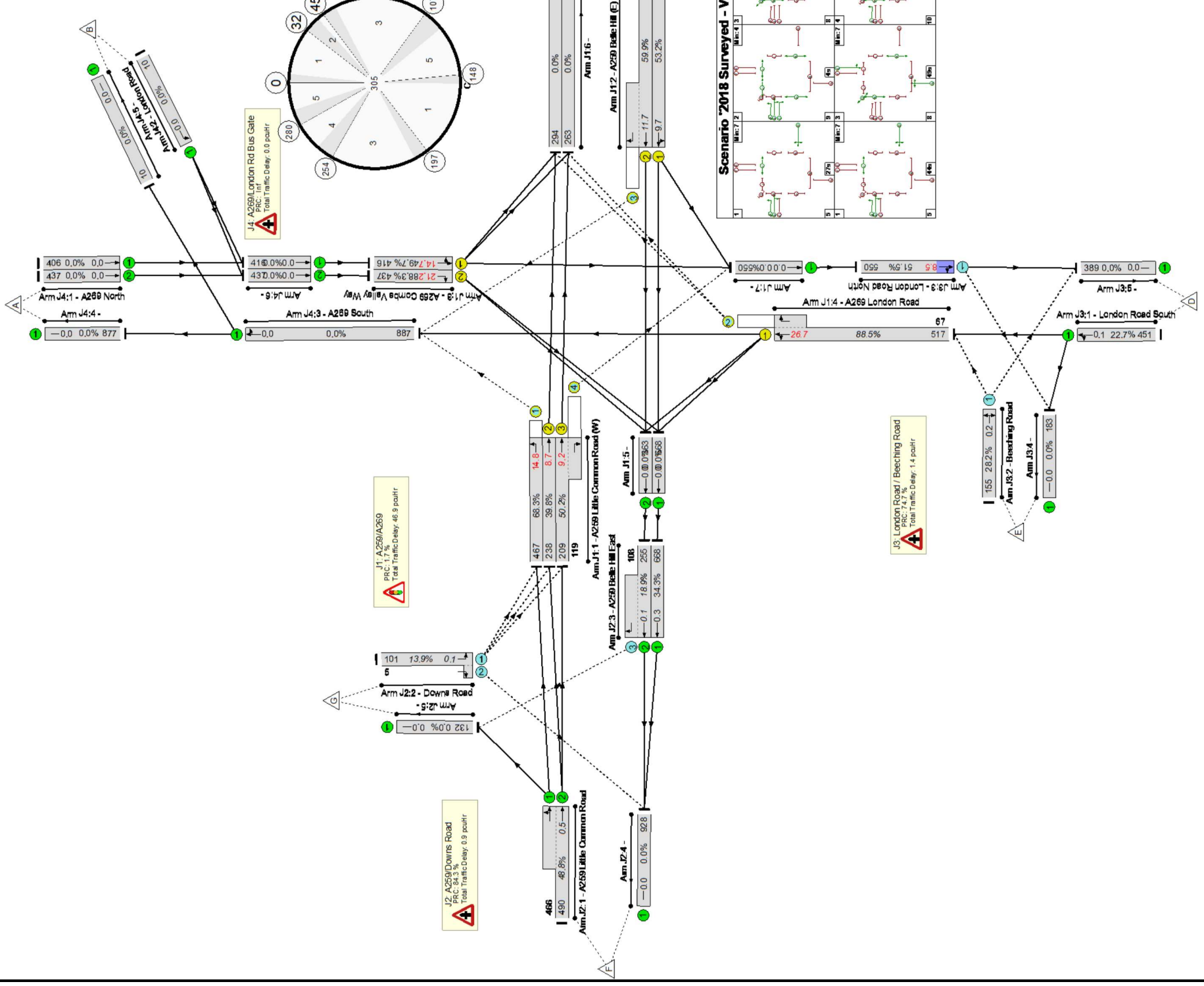

**Network Results**

Item	Lane Description	Full Phase	Demand Flow (pcu)	Sat Flow (pcu/Hr)	Capacity (pcu)	Deg Sat (%)	Uniform Delay (pcuHr)	Rand + Oversat Delay (pcuHr)	Total Delay (pcuHr)	Av. Delay Per PCU (s/pcu)	Max. Back of Uniform Queue (pcu)	Rand + Oversat Queue (pcu)	Mean Max Queue (pcu)
<b>Network: A259/A269 Existing Layout</b>	-	-	-	-	-	<b>88.5%</b>	<b>35.8</b>	<b>12.4</b>	<b>49.3</b>	-	-	-	-
<b>J1: A259/A269</b>	-	-	-	-	-	<b>88.5%</b>	<b>35.3</b>	<b>10.6</b>	<b>46.9</b>	-	-	-	-
1/1	A259 Little Common Road (W) Left	A	467	1859	684	68.3%	2.8	1.1	4.2	32.2	13.8	1.1	14.8
1/2	A259 Little Common Road (W) Ahead	B	238	2120	598	39.8%	2.9	0.3	3.3	49.3	8.3	0.3	8.7
1/3+1/4	A259 Little Common Road (W) Ahead Right	B	328	2120:1927	653	50.2%	4.0	0.5	5.0	54.7	8.7	0.5	9.2
2/1	A259 Belle Hill (E) Ahead Left	D	239	1877	449	53.2%	3.4	0.6	3.9	59.1	9.1	0.6	9.7
2/2+2/3	A259 Belle Hill (E) Ahead Right	D	316	2085:1895	528	59.9%	4.4	0.7	5.3	60.0	11.0	0.7	11.7
3/1	A269 Combe Valley Way Left Ahead	E	416	1948	837	49.7%	3.7	0.5	4.2	36.2	14.2	0.5	14.7
3/2	A269 Combe Valley Way Right	F	437	1936	495	88.3%	6.6	3.4	10.0	82.3	17.8	3.4	21.2
4/1+4/2	A269 London Road Left Right Ahead	G	584	1847:1856	660	88.5%	7.5	3.5	11.2	68.8	23.2	3.5	26.7
<b>J2: A259/Downs Road</b>	-	-	-	-	-	<b>48.8%</b>	<b>0.0</b>	<b>0.9</b>	<b>0.9</b>	-	-	-	-
1/2+1/1	A259 Little Common Road Ahead Left	-	956	1965:1951	1958	48.8%	0.0	0.5	0.5	1.8	0.0	0.5	0.5
2/1+2/2	Downs Road Left Right	-	106	1773:1764	764	13.9%	0.0	0.1	0.1	2.7	0.0	0.1	0.1
3/1	A259 Belle Hill East Ahead	-	668	1950	1950	34.3%	0.0	0.3	0.3	1.4	0.0	0.3	0.3
3/2+3/3	A259 Belle Hill East Ahead Right	-	363	2085:1612	1918	18.9%	0.0	0.1	0.1	1.2	0.0	0.1	0.1
<b>J3: London Road / Beeching Road</b>	-	-	-	-	-	<b>51.5%</b>	<b>0.6</b>	<b>0.9</b>	<b>1.4</b>	-	-	-	-
1/1	London Road South Ahead Left	-	451	1984	1984	22.7%	0.0	0.1	0.1	1.2	0.0	0.1	0.1

Full Input Data And Results

2/1	Beeching Road Left Right	-	155	1677	550	28.2%	0.0	0.2	0.2	4.6	0.0	0.2	0.2
3/1	London Road North Right Ahead	-	550	1867	1068	51.5%	0.6	0.5	1.1	7.1	8.0	0.5	8.5
<b>J4: A269/London Rd Bus Gate</b>	-	-	-	-	-	<b>0.0%</b>	<b>0.0</b>	<b>0.0</b>	<b>0.0</b>	-	-	-	-
C1		PRC for Signalled Lanes (%):		1.7	Total Delay for Signalled Lanes (pcuHr):		46.94	Cycle Time (s):		305			
		PRC Over All Lanes (%):		1.7	Total Delay Over All Lanes(pcuHr):		49.31						

**Stage Sequence Diagram**

**Scenario 3: '2025 Assessment Flows - Inc Bexhill Leisure Trips - AM Peak' (FG3: '2025 Assessment Flows - Inc Bexhill Leisure Trips - AM Peak', Plan 1: 'Capture Double')**

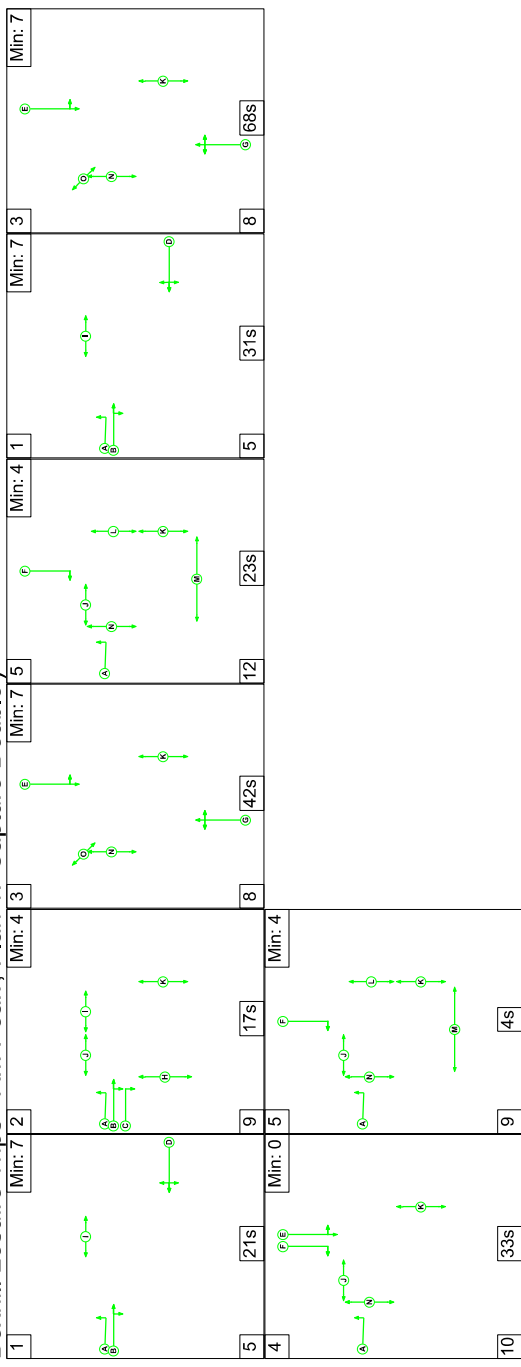



**Network Results**

Item	Lane Description	Full Phase	Demand Flow (pcu)	Sat Flow (pcu/Hr)	Capacity (pcu)	Deg Sat (%)	Uniform Delay (pcuHr)	Rand + Oversat Delay (pcuHr)	Total Delay (pcuHr)	Av. Delay Per PCU (s/pcu)	Max. Back of Uniform Queue (pcu)	Rand + Oversat Queue (pcu)	Mean Max Queue (pcu)
<b>Network: A259/A269 Existing Layout</b>	-	-	-	-	-	<b>102.6%</b>	<b>57.1</b>	<b>42.8</b>	<b>102.1</b>	-	-	-	-
<b>J1: A259/A269</b>	-	-	-	-	-	<b>89.8%</b>	<b>44.5</b>	<b>16.7</b>	<b>63.4</b>	-	-	-	-
1/1	A259 Little Common Road (W) Left	A	496	1859	665	74.6%	3.5	1.4	5.4	39.1	18.5	1.4	19.9
1/2	A259 Little Common Road (W) Ahead	B	496	2120	556	89.2%	7.8	3.7	11.5	83.2	24.4	3.7	28.1
1/3+1/4	A259 Little Common Road (W) Ahead Right	B	262	2120:1927	292	89.8%	4.3	3.6	9.1	124.8	12.9	3.6	16.4
2/1	A259 Belle Hill (E) Ahead Left	D	206	1864	330	62.4%	3.3	0.8	4.2	72.8	8.7	0.8	9.5
2/2+2/3	A259 Belle Hill (E) Ahead Right	D	235	2085:1895	374	62.8%	3.8	0.8	4.7	71.6	9.9	0.8	10.7
3/1	A269 Combe Valley Way Left Ahead	E	792	1952	992	79.8%	7.7	1.9	9.6	43.8	32.1	1.9	34.1
3/2	A269 Combe Valley Way Right	F	383	1936	489	78.4%	5.7	1.8	7.4	69.7	15.7	1.8	17.5
4/1+4/2	A269 London Road Left Right Ahead	G	584	1799:1856	687	85.1%	8.3	2.7	11.6	71.4	25.7	2.7	28.4
<b>J2: A259/Downs Road</b>	-	-	-	-	-	<b>52.9%</b>	<b>0.0</b>	<b>1.5</b>	<b>1.5</b>	-	-	-	-
1/2+1/1	A259 Little Common Road Ahead Left	-	1033	1965:1938	1954	52.9%	0.0	0.6	0.6	2.0	0.0	0.6	0.6
2/1+2/2	Downs Road Left Right	-	286	1773:1764	724	39.5%	0.0	0.3	0.3	4.1	0.0	0.3	0.3
3/1	A259 Belle Hill East Ahead	-	697	1950	1950	35.7%	0.0	0.3	0.3	1.4	0.0	0.3	0.3
3/2+3/3	A259 Belle Hill East Ahead Right	-	366	2085:1612	985	37.1%	0.0	0.3	0.3	2.9	0.6	0.3	0.9
<b>J3: London Road / Beeching Road</b>	-	-	-	-	-	<b>102.6%</b>	<b>12.6</b>	<b>24.6</b>	<b>37.2</b>	-	-	-	-
1/1	London Road South Ahead Left	-	435	1987	1987	21.9%	0.0	0.1	0.1	1.2	0.0	0.1	0.1

Full Input Data And Results

2/1	Beeching Road Left Right	-	164	1679	552	29.7%	0.0	0.2	0.2	4.6	0.0	0.2	0.2
3/1	London Road North Right Ahead	-	1051	1854	1024	102.6%	12.6	24.2	36.8	126.2	132.0	24.2	156.2
<b>J4: A269/London Rd Bus Gate</b>	-	-	-	-	-	<b>0.0%</b>	<b>0.0</b>	<b>0.0</b>	<b>0.0</b>	-	-	-	-
C1		PRC for Signalled Lanes (%):	0.2	Total Delay for Signalled Lanes (pcuHr):		63.41	Cycle Time (s):		305				
		PRC Over All Lanes (%):	-14.0	Total Delay Over All Lanes(pcuHr):		102.05							

**Stage Sequence Diagram**

**Scenario 4: '2025 Assessment Flows - Inc Bexhill Lesuire Trips - PM Peak' (FG4: '2025 Assessment Flows - Inc Bexhill Lesuire Trips - PM Peak', Plan 1: 'Capture Double')**

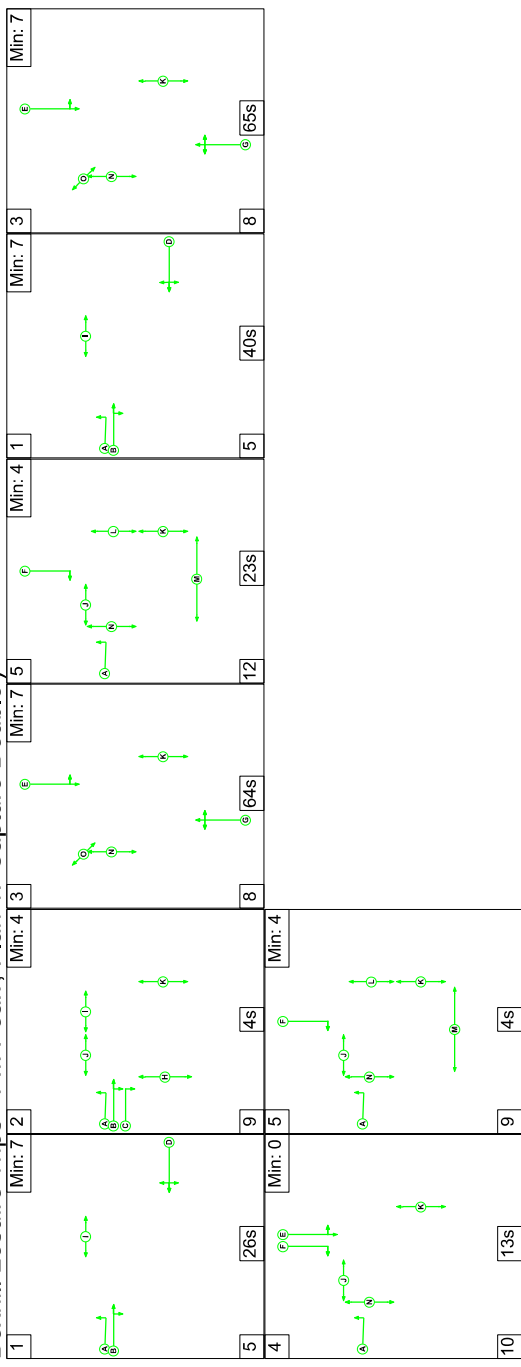



### Network Layout Diagram

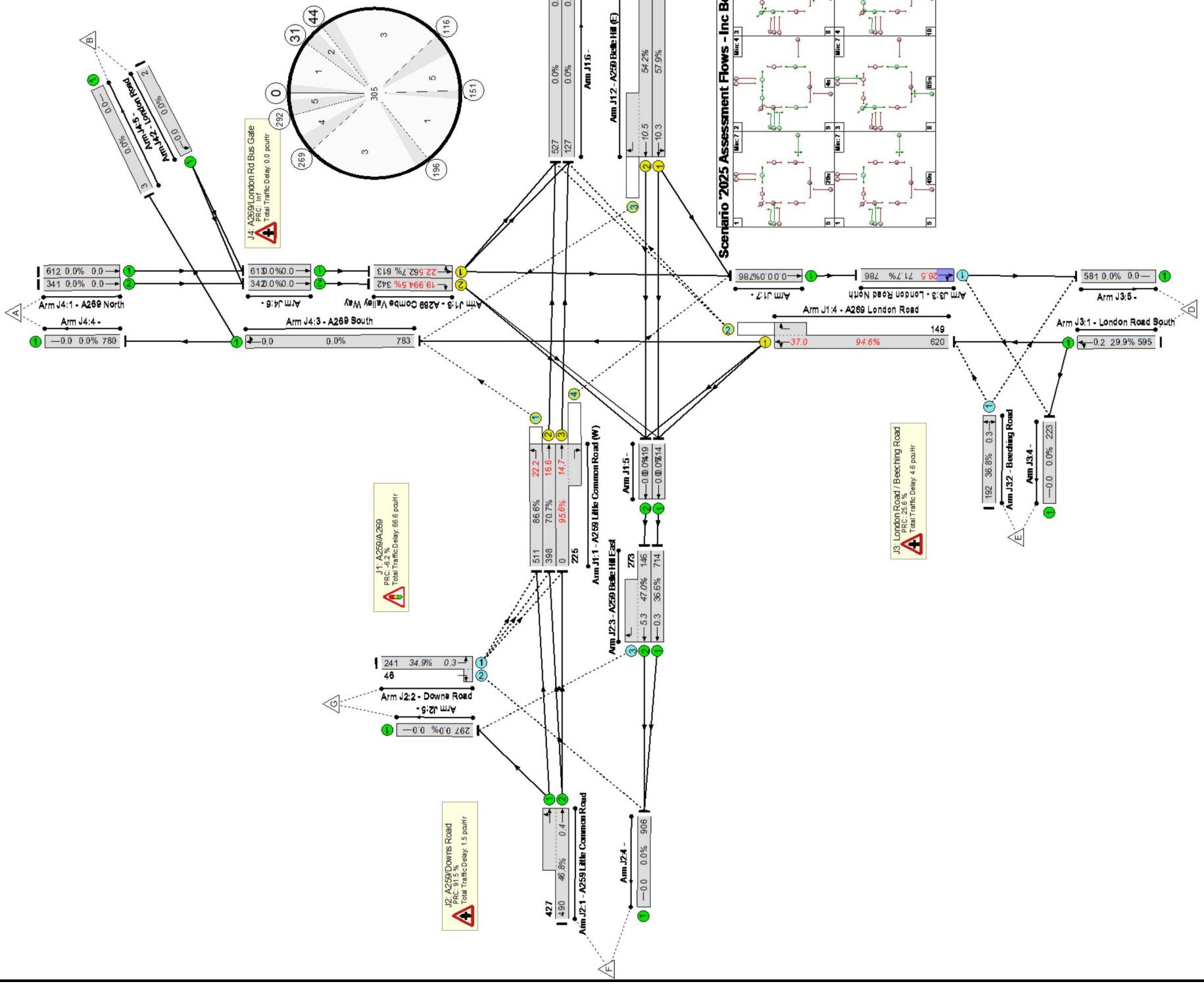

**Network Results**

Item	Lane Description	Full Phase	Demand Flow (pcu)	Sat Flow (pcu/Hr)	Capacity (pcu)	Deg Sat (%)	Uniform Delay (pcuHr)	Rand + Oversat Delay (pcuHr)	Total Delay (pcuHr)	Av. Delay Per PCU (s/pcu)	Max. Back of Uniform Queue (pcu)	Rand + Oversat Queue (pcu)	Mean Max Queue (pcu)
<b>Network: A259/A269 Existing Layout</b>	-	-	-	-	-	<b>95.6%</b>	<b>43.1</b>	<b>27.1</b>	<b>72.7</b>	-	-	-	-
<b>J1: A259/A269</b>	-	-	-	-	-	<b>95.6%</b>	<b>40.3</b>	<b>23.9</b>	<b>66.6</b>	-	-	-	-
1/1	A259 Little Common Road (W) Left	A	511	1859	590	86.6%	4.8	3.0	8.3	58.2	19.2	3.0	22.2
1/2	A259 Little Common Road (W) Ahead	B	398	2120	563	70.7%	5.6	1.2	6.8	61.4	15.4	1.2	16.6
1/3+1/4	A259 Little Common Road (W) Ahead Right	B	225	2120:1927	235	95.6%	3.4	5.4	9.9	159.1	9.4	5.4	14.7
2/1	A259 Belle Hill (E) Ahead Left	D	243	1881	419	57.9%	3.6	0.7	4.3	63.1	9.6	0.7	10.3
2/2+2/3	A259 Belle Hill (E) Ahead Right	D	255	2085:1895	470	54.2%	3.7	0.6	4.3	61.0	9.9	0.6	10.5
3/1	A269 Combe Valley Way Left Ahead	E	613	1937	978	62.7%	4.8	0.8	5.6	32.9	21.6	0.8	22.5
3/2	A269 Combe Valley Way Right	F	342	1936	362	94.5%	5.8	5.5	11.4	119.5	14.3	5.5	19.9
4/1+4/2	A269 London Road Left Right Ahead	G	769	1800:1856	813	94.6%	8.6	6.7	16.1	75.5	30.3	6.7	37.0
<b>J2: A259/Downs Road</b>	-	-	-	-	-	<b>47.0%</b>	<b>0.0</b>	<b>1.4</b>	<b>1.5</b>	-	-	-	-
1/2+1/1	A259 Little Common Road Ahead Left	-	917	1965:1950	1958	46.8%	0.0	0.4	0.4	1.7	0.0	0.4	0.4
2/1+2/2	Downs Road Left Right	-	287	1773:1764	821	34.9%	0.0	0.3	0.3	3.4	0.0	0.3	0.3
3/1	A259 Belle Hill East Ahead	-	714	1950	1950	36.6%	0.0	0.3	0.3	1.5	0.0	0.3	0.3
3/2+3/3	A259 Belle Hill East Ahead Right	-	419	2085:1612	892	47.0%	0.0	0.4	0.5	4.2	4.9	0.4	5.3
<b>J3: London Road / Beeching Road</b>	-	-	-	-	-	<b>71.7%</b>	<b>2.8</b>	<b>1.8</b>	<b>4.6</b>	-	-	-	-
1/1	London Road South Ahead Left	-	595	1988	1988	29.9%	0.0	0.2	0.2	1.3	0.0	0.2	0.2

Full Input Data And Results

2/1	Beeching Road Left Right	-	192	1680	521	36.8%	0.0	0.3	0.3	5.5	0.0	0.3	0.3
3/1	London Road North Right Ahead	-	786	1884	1096	71.7%	2.8	1.3	4.1	18.7	25.2	1.3	26.5
<b>J4: A269/London Rd Bus Gate</b>	-	-	-	-	-	<b>0.0%</b>	<b>0.0</b>	<b>0.0</b>	<b>0.0</b>	-	-	-	-
C1		PRC for Signalled Lanes (%):	-6.2	Total Delay for Signalled Lanes (pcuHr):		66.64	Cycle Time (s):		305				
		PRC Over All Lanes (%):	-6.2	Total Delay Over All Lanes(pcuHr):		72.71							

### Stage Sequence Diagram

Scenario 5: '2031 Assessment Flows - Inc Bexhill Leisure Trips - AM Peak' (FG5: '2031 Assessment Flows - Inc Bexhill Leisure Trips - AM Peak', Plan 1: 'Capture Double')

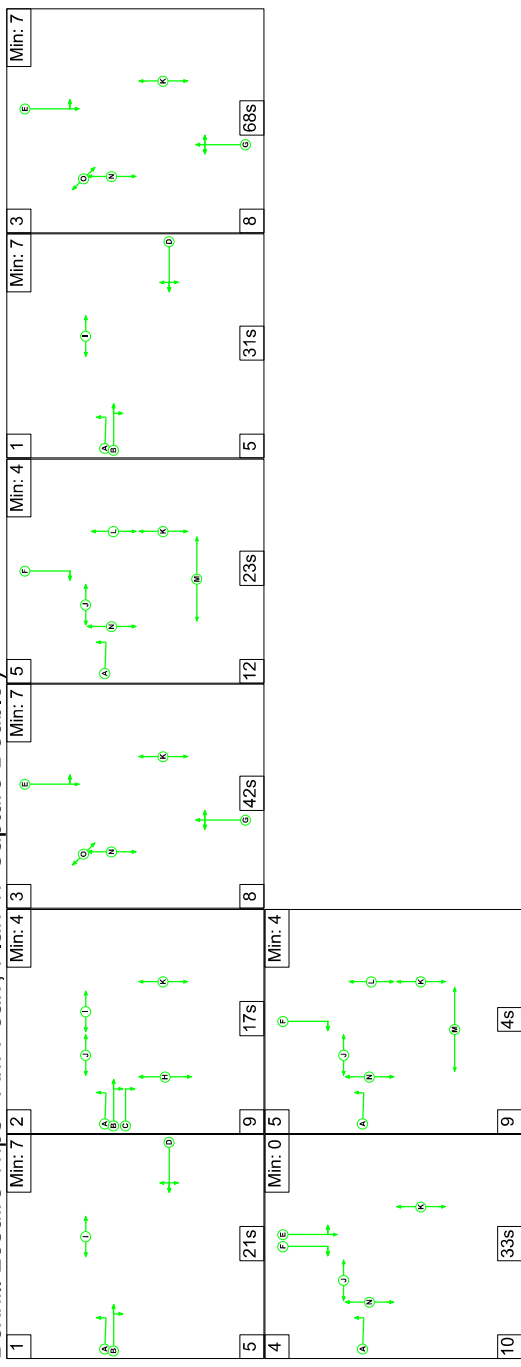

Network Layout Diagram

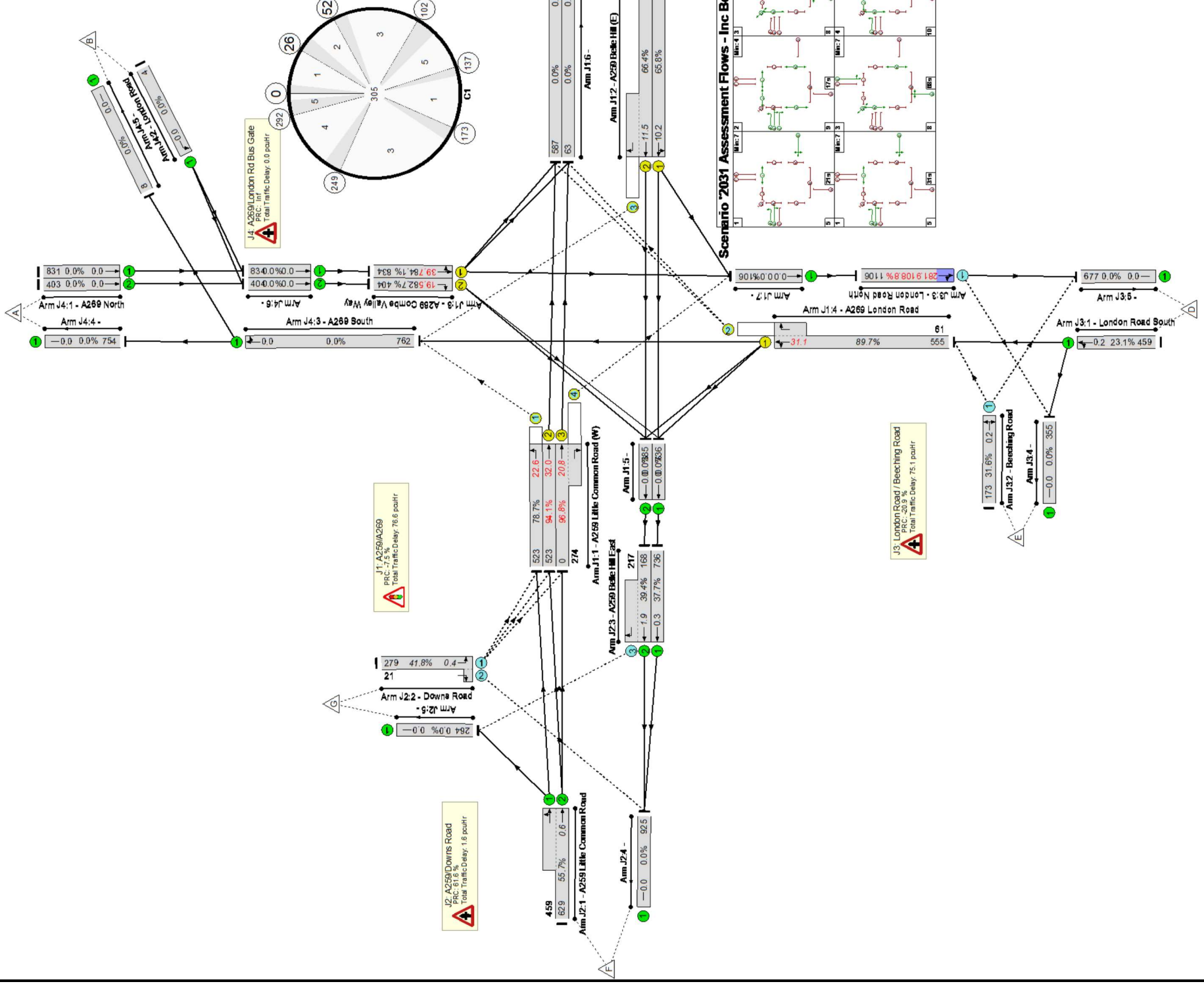

**Network Results**

Item	Lane Description	Full Phase	Demand Flow (pcu)	Sat Flow (pcu/Hr)	Capacity (pcu)	Deg Sat (%)	Uniform Delay (pcuHr)	Rand + Oversat Delay (pcuHr)	Total Delay (pcuHr)	Av. Delay Per PCU (s/pcu)	Max. Back of Uniform Queue (pcu)	Rand + Oversat Queue (pcu)	Mean Max Queue (pcu)
<b>Network: A259/A269 Existing Layout</b>	-	-	-	-	-	<b>108.8%</b>	<b>73.8</b>	<b>77.0</b>	<b>153.2</b>	-	-	-	-
<b>J1: A259/A269</b>	-	-	-	-	-	<b>96.8%</b>	<b>49.6</b>	<b>24.6</b>	<b>76.6</b>	-	-	-	-
1/1	A259 Little Common Road (W) Left	A	523	1859	665	78.7%	3.9	1.8	6.1	42.3	20.8	1.8	22.6
1/2	A259 Little Common Road (W) Ahead	B	523	2120	556	94.1%	8.4	5.8	14.2	97.7	26.2	5.8	32.0
1/3+1/4	A259 Little Common Road (W) Ahead Right	B	274	2120:1927	283	96.8%	5.0	6.3	12.6	165.5	14.5	6.3	20.8
2/1	A259 Belle Hill (E) Ahead Left	D	217	1863	330	65.8%	3.5	0.9	4.5	74.5	9.2	0.9	10.2
2/2+2/3	A259 Belle Hill (E) Ahead Right	D	248	2085:1895	374	66.4%	4.1	1.0	5.1	73.3	10.5	1.0	11.5
3/1	A269 Combe Valley Way Left Ahead	E	834	1952	992	84.1%	9.0	2.6	11.5	49.7	37.1	2.6	39.7
3/2	A269 Combe Valley Way Right	F	404	1936	489	82.7%	6.2	2.3	8.5	75.5	17.3	2.3	19.5
4/1+4/2	A269 London Road Left Right Ahead	G	616	1799:1856	686	89.7%	9.5	3.9	14.1	82.3	27.1	3.9	31.1
<b>J2: A259/Downs Road</b>	-	-	-	-	-	<b>55.7%</b>	<b>0.0</b>	<b>1.6</b>	<b>1.6</b>	-	-	-	-
1/2+1/1	A259 Little Common Road Ahead Left	-	1088	1965:1938	1954	55.7%	0.0	0.6	0.6	2.1	0.0	0.6	0.6
2/1+2/2	Downs Road Left Right	-	300	1773:1764	718	41.8%	0.0	0.4	0.4	4.3	0.0	0.4	0.4
3/1	A259 Belle Hill East Ahead	-	736	1950	1950	37.7%	0.0	0.3	0.3	1.5	0.0	0.3	0.3
3/2+3/3	A259 Belle Hill East Ahead Right	-	385	2085:1612	976	39.4%	0.0	0.3	0.3	3.0	1.5	0.3	1.9
<b>J3: London Road / Beeching Road</b>	-	-	-	-	-	<b>108.8%</b>	<b>24.3</b>	<b>50.8</b>	<b>75.1</b>	-	-	-	-
1/1	London Road South Ahead Left	-	459	1987	1987	23.1%	0.0	0.2	0.2	1.2	0.0	0.2	0.2

Full Input Data And Results

2/1	Beeching Road Left Right	-	173	1680	548	31.6%	0.0	0.2	0.2	4.8	0.0	0.2	0.2
3/1	London Road North Right Ahead	-	1106	1853	1016	108.8%	24.3	50.4	74.7	243.1	231.5	50.4	281.9
<b>J4: A269/London Rd Bus Gate</b>	-	-	-	-	-	<b>0.0%</b>	<b>0.0</b>	<b>0.0</b>	<b>0.0</b>	-	-	-	-
C1		PRC for Signalled Lanes (%):	-7.5	Total Delay for Signalled Lanes (pcuHr):		76.55	Cycle Time (s):		305				
		PRC Over All Lanes (%):	-20.9	Total Delay Over All Lanes(pcuHr):		153.23							

**Stage Sequence Diagram**

**Scenario 6: '2031 Assessment Flows - Inc Bexhill Lesuire Trips - PM Peak' (FG6: '2031 Assessment Flows - Inc Bexhill Lesuire Trips - PM Peak', Plan 1: 'Capture Double')**

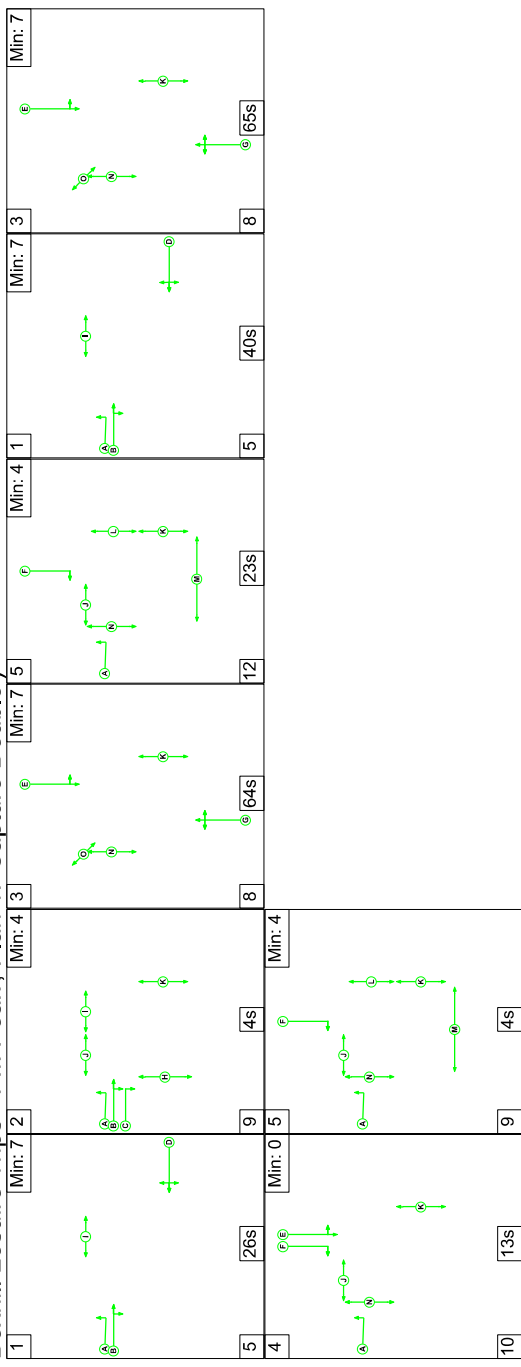



### Network Layout Diagram

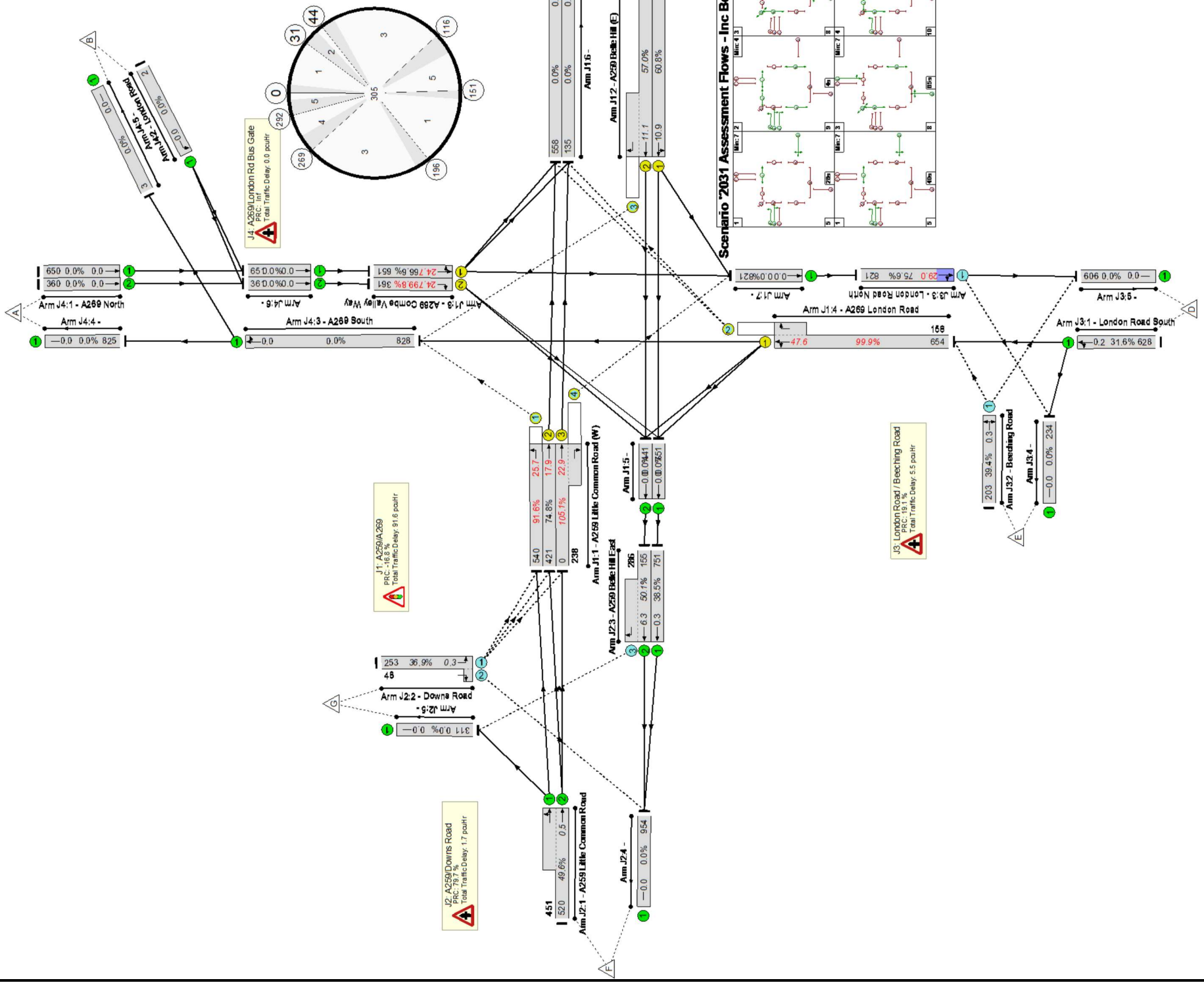

## Network Results

Item	Lane Description	Full Phase	Demand Flow (pcu)	Sat Flow (pcu/Hr)	Capacity (pcu)	Deg Sat (%)	Uniform Delay (pcuHr)	Rand + Oversat Delay (pcuHr)	Total Delay (pcuHr)	Av. Delay Per PCU (s/pcu)	Max. Back of Uniform Queue (pcu)	Rand + Oversat Queue (pcu)	Mean Max Queue (pcu)
<b>Network: A259/A269 Existing Layout</b>	-	-	-	-	-	<b>105.1%</b>	<b>48.7</b>	<b>46.6</b>	<b>98.8</b>	-	-	-	-
<b>J1: A259/A269</b>	-	-	-	-	-	<b>105.1%</b>	<b>45.2</b>	<b>42.9</b>	<b>91.6</b>	-	-	-	-
1/1	A259 Little Common Road (W) Left	A	540	1859	590	91.6%	5.3	4.6	10.4	69.2	21.2	4.6	25.7
1/2	A259 Little Common Road (W) Ahead	B	421	2120	563	74.8%	6.0	1.5	7.5	63.7	16.5	1.5	17.9
1/3+1/4	A259 Little Common Road (W) Ahead Right	B	238	2120:1927	226	105.1%	5.1	11.2	18.4	278.1	11.7	11.2	22.9
2/1	A259 Belle Hill (E) Ahead Left	D	255	1881	419	60.8%	3.8	0.8	4.5	64.2	10.1	0.8	10.9
2/2+2/3	A259 Belle Hill (E) Ahead Right	D	268	2085:1895	470	57.0%	3.9	0.7	4.6	61.9	10.5	0.7	11.1
3/1	A269 Combe Valley Way Left Ahead	E	651	1937	978	66.6%	5.2	1.0	6.2	34.3	23.7	1.0	24.7
3/2	A269 Combe Valley Way Right	F	361	1936	362	99.8%	6.3	9.3	15.6	155.1	15.4	9.3	24.7
4/1+4/2	A269 London Road Left Right Ahead	G	812	1800:1856	813	99.9%	9.6	14.0	24.5	108.5	33.6	14.0	47.6
<b>J2: A259/Downs Road</b>	-	-	-	-	-	<b>50.1%</b>	<b>0.1</b>	<b>1.6</b>	<b>1.7</b>	-	-	-	-
1/2+1/1	A259 Little Common Road Ahead Left	-	971	1965:1950	1958	49.6%	0.0	0.5	0.5	1.8	0.0	0.5	0.5
2/1+2/2	Downs Road Left Right	-	301	1773:1764	815	36.9%	0.0	0.3	0.3	3.5	0.0	0.3	0.3
3/1	A259 Belle Hill East Ahead	-	751	1950	1950	38.5%	0.0	0.3	0.3	1.5	0.0	0.3	0.3
3/2+3/3	A259 Belle Hill East Ahead Right	-	441	2085:1612	881	50.1%	0.1	0.5	0.6	4.8	5.8	0.5	6.3
<b>J3: London Road / Beeching Road</b>	-	-	-	-	-	<b>75.6%</b>	<b>3.4</b>	<b>2.1</b>	<b>5.5</b>	-	-	-	-
1/1	London Road South Ahead Left	-	628	1988	1988	31.6%	0.0	0.2	0.2	1.3	0.0	0.2	0.2

Full Input Data And Results

2/1	Beeching Road Left Right	-	203	1680	515	39.4%	0.0	0.3	0.3	5.8	0.0	0.3	0.3
3/1	London Road North Right Ahead	-	833	1884	1087	75.6%	3.4	1.5	5.0	21.7	27.5	1.5	29.0
<b>J4: A269/London Rd Bus Gate</b>	-	-	-	-	-	<b>0.0%</b>	<b>0.0</b>	<b>0.0</b>	<b>0.0</b>	-	-	-	-
C1		PRC for Signalled Lanes (%):	-16.8	Total Delay for Signalled Lanes (pcuHr):		91.62	Cycle Time (s):		305				
		PRC Over All Lanes (%):	-16.8	Total Delay Over All Lanes(pcuHr):		98.82							