

PLAN REFERRED TO IN THE COUNTY OF EAST SUSSEX  
(Broadland Row, Udimore Road, Brede)  
DIRECTION 1972

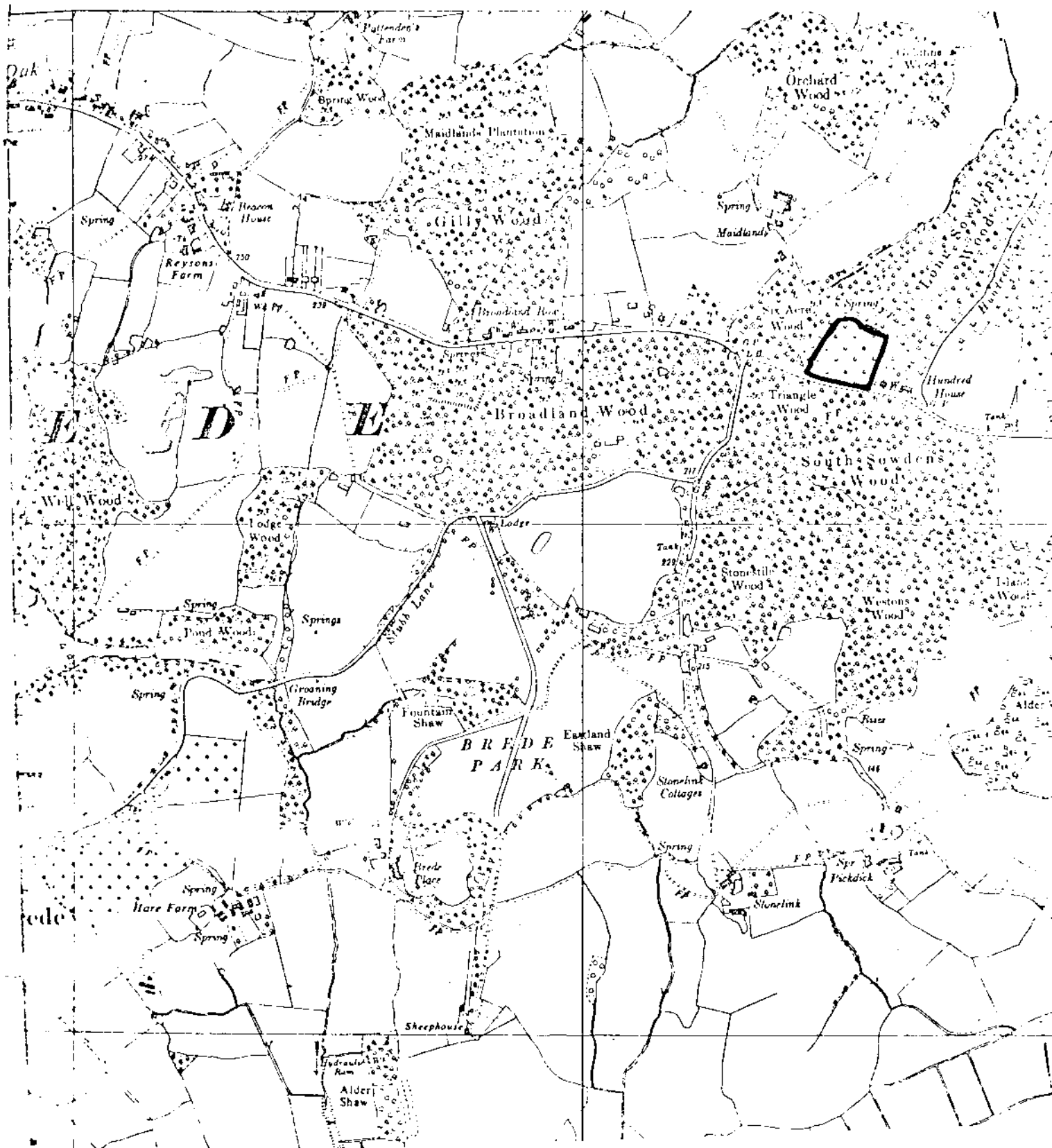

DATE

LAND AT UDIMORE ROAD BREDE.  
MR. S. E. MOON.

Scale : 1/2500.

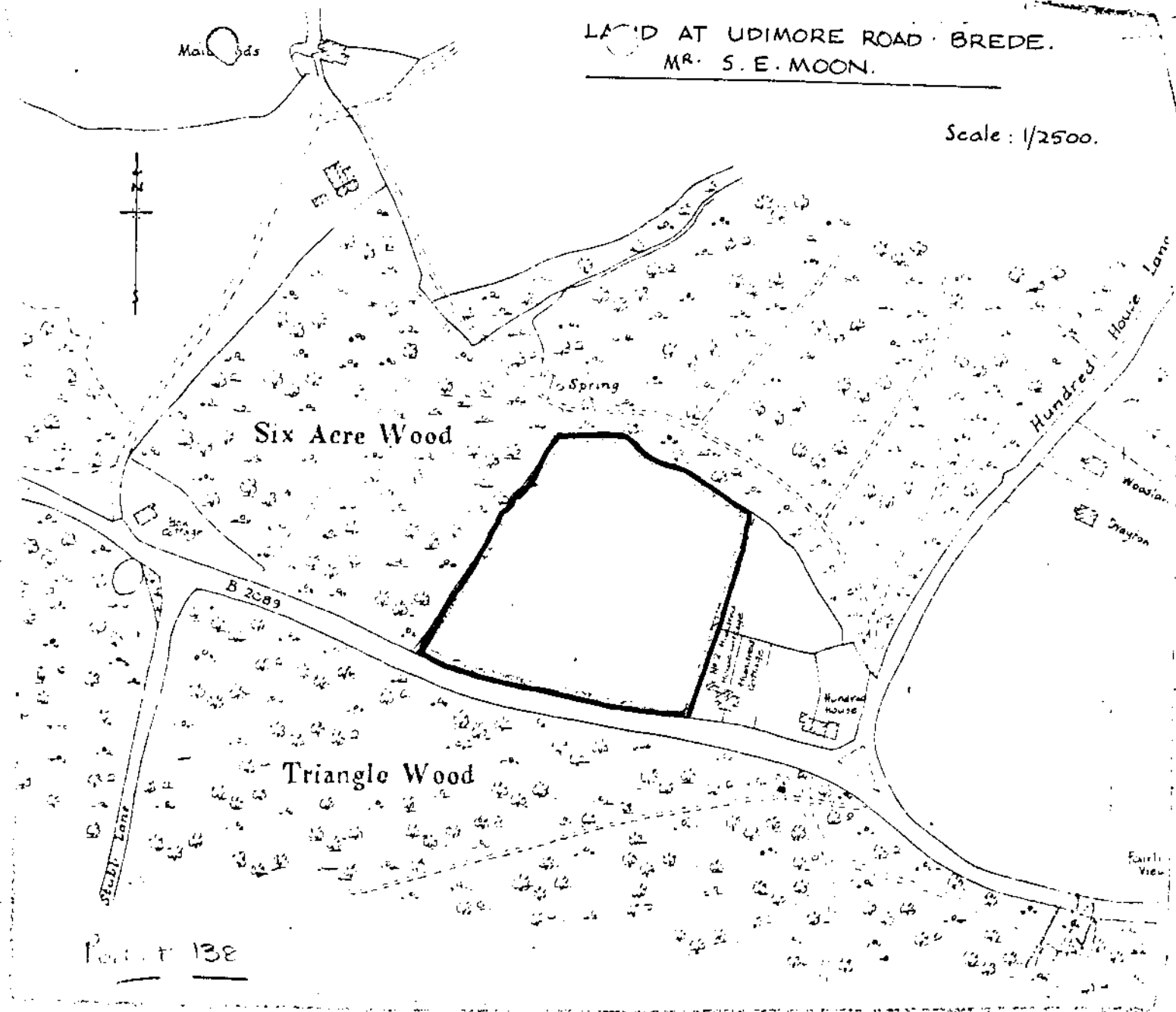

COPY

(S. 1111)

9

.

D

**I**

## Part I

- 



- + Class IX. The carrying out of works required for the maintenance or improvement of an unadopted street or private way on land within the boundaries of the street or way being development comprised within Class IX of the First Schedule to the Order and not within any other Class.
- 7 Class XXIII. The use of land, other than a building, as a caravan site in any of the circumstances specified in paragraphs 2 to 9 (inclusive) of the First Schedule to the Caravan Sites and Control of Development Act, 1960, or in the circumstances (other than those relating to winter quarters) specified in paragraph 10 of the said Schedule.

Part II

Land situate in the parish of Brede on the north side of the road leading from Battle to Rye (E.2089) comprising the greater part of Ordnance Parcel Number 54 on the Ordnance Survey Sussex (East) Sheet XLIV.12 (Edition of 1929) and shown edged pink on the plan attached hereto.

GIVEN under the Common Seal of the County Council this  
*Tenth* day of *September* One thousand nine hundred  
and sixty-two.

(L.S.)

{ THE COMMON SEAL of THE COUNTY COUNCIL  
OF EAST SUSSEX was affixed hereto in  
the presence of :-

*WILLIAM LINDSAY*

Chairman of the County Council  
and of

*J. ATKINSON*

Clerk of the County Council.