

This copy has been produced specifically to supply an individual with authority information. No further copies may be made.
Reproduced from the Ordnance Survey Mapping with the permission of the Controller of Her Majesty's Stationery Office. Crown copyright.
Unauthorised reproduction infringes Crown copyright and may lead to prosecution or civil proceedings.
Rother District Council Licence No LA079154

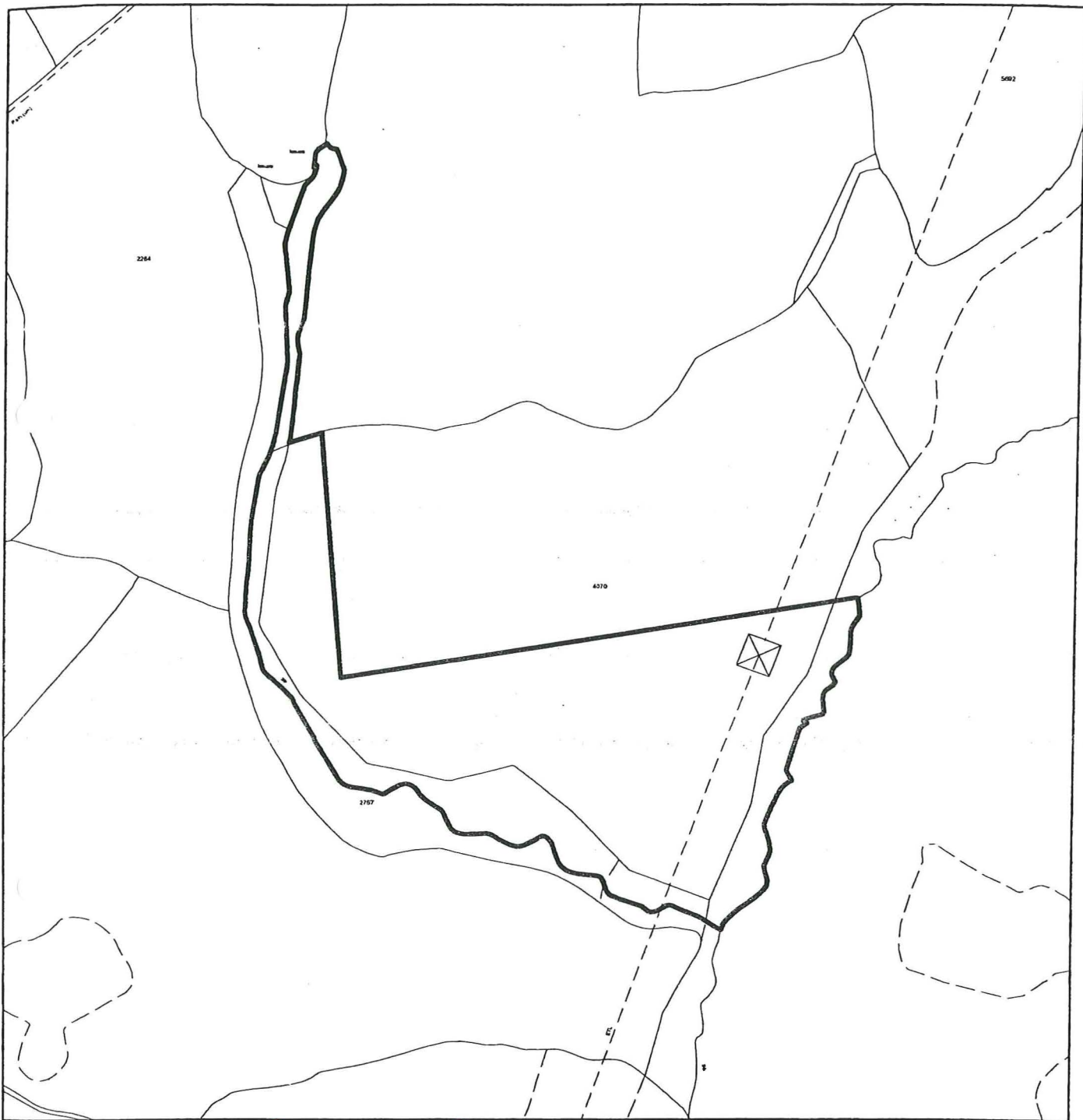

3/29/4
[Signature]
Chairman of the Council
LEADER
[Signature]
Chief Executive

Plan: Enforcement
File: ENF/BRE/2003/546
Scale: 1:2500
Date: 01/04/2004
N.G. Ref: TQ8119NW

ROTHER DISTRICT COUNCIL**TOWN AND COUNTRY PLANNING (GENERAL PERMITTED
DEVELOPMENT) ORDER 1995****DIRECTION MADE UNDER ARTICLE 4(1) TO WHICH
ARTICLE 5(4) APPLIES**

WHEREAS the Council of the District of Rother being the appropriate local planning authority within the meaning of Article 4(6) of the Town and Country Planning (General Permitted Development) Order 1995 are satisfied that it is expedient that development of the descriptions set out in the Schedule below should not be carried out on the land at Goatham Lane, Brede, East Sussex shown edged by a thick black line on the attached plan, unless permission is granted on an application made under Part III of the Town and Country Planning Act 1990,

AND WHEREAS the Council consider that development of the said descriptions would be prejudicial to the proper planning of their area, and would constitute a threat to the amenities of their area and that the provisions of paragraph 4 of Article 5 of the Town and Country Planning (General Permitted Development) Order 1995 apply,

NOW THEREFORE the said Council in pursuance of the power conferred upon them by Article 4(1) of the Town and Country Planning (General Permitted Development) Order 1995 hereby direct that the permission granted by Article 3 of the said Order shall not apply to development on the said land of the descriptions set out in the Schedule below,

THIS DIRECTION is made under Article 4(1) of the said Order and, in accordance with Article 5(4), shall remain in force until 31 October 2004 (being 6 months from the date of this Direction) and shall then expire unless it has been approved by the First Secretary of State

THIS DIRECTION may be cited as the Rother District Council (Goatham Lane, Brede, East Sussex) Article 4 Direction 2004.

SCHEDULE

1. The erection, construction, maintenance, improvement or alteration of a gate, fence, wall or other means of enclosure; being development comprised within Part 2 Class A referred to in the Second Schedule to the said Order and not being development within any other Class;
2. The formation, laying out and construction of a means of access to a highway which is not a trunk road or a classified road, where that access is required in connection with development permitted by any Class in the Second Schedule to the said Order (other than by Class A of Part 2); being development comprised within Part 2 Class B referred to in the Second Schedule to the said Order and not being development within any other class;

3. The use of any land for any purpose for not more than 28 days in total in any calendar year (of which not more than 14 days in total may be for the purpose:s of: (a) the holding of a market; (b) motor car and motor cycle racing including trials of speed, and practising for these activities) and the provision on the land of any moveable structure for the purposes of the permitted use; being development comprised within Part 4 Class B referred to in the Second Schedule to the said Order and not being development within any other Class;

GIVEN under the Common Seal of the Rother District Council this 2 April 2004

THE COMMON SEAL of ROTHER DISTRICT)
COUNCIL was hereunto affixed in the)
presence of:-)



~~Chairman~~ of the Council
LEADER

Chief Executive

The First Secretary of State hereby approves the foregoing Direction



Signed by Authority of An Authorised Officer in the
the First Secretary of State Government Office of the South East

30 April 2004